

## Register Search Statement - Volume 8602 Folio 172

Copyright State of Victoria. This publication is copyright. No part may be reproduced by any process except in accordance with the provisions of the Copyright Act 1968 (Cth) and for the purposes of Section 32 of the Sale of Land Act 1962 (Vic) or pursuant to a written agreement. The information is only valid at the time and in the form obtained from the LANDATA REGD TM System. The State of Victoria accepts no responsibility for any subsequent release, publication or reproduction of the information.

## REGISTER SEARCH STATEMENT (Title Search) Transfer of Land Act 1958

VOLUME 08602 FOLIO 172

Security no : 124080105627U  
Produced 06/11/2019 05:46 PM

## LAND DESCRIPTION

**ADVERTISED COPY**

Lot 2 on Plan of Subdivision 071049.

## PARENT TITLES :

Volume 08566 Folio 581 to Volume 08566 Folio 582  
Created by instrument LP071049 17/02/1966

## REGISTERED PROPRIETOR

Estate Fee Simple

Sole Proprietor

GREATLAND INVESTMENT PTY LTD of 4 MARGARET STREET OAKLEIGH SOUTH VIC 3167  
AB089769B 20/02/2002

## ENCUMBRANCES, CAVEATS AND NOTICES

MORTGAGE AK047409S 27/11/2012  
WESTPAC BANKING CORPORATION

Any encumbrances created by Section 98 Transfer of Land Act 1958 or Section 24 Subdivision Act 1988 and any other encumbrances shown or entered on the plan or imaged folio set out under DIAGRAM LOCATION below.

## DIAGRAM LOCATION

SEE LP071049 FOR FURTHER DETAILS AND BOUNDARIES

## ACTIVITY IN THE LAST 125 DAYS

NIL

-----END OF REGISTER SEARCH STATEMENT-----

Additional information: (not part of the Register Search Statement)

Street Address: 4 MARGARET STREET OAKLEIGH SOUTH VIC 3167

## ADMINISTRATIVE NOTICES

NIL

eCT Control 16320Q WESTPAC BANKING CORPORATION  
Effective from 23/10/2016

DOCUMENT END

...publication is copyright. No part may be reproduced by any process except in accordance with the provisions of the Copyright Act and the  
...of the Sale of Land Act 1962 or pursuant to a written agreement. The information is only valid at the time and in the form obtained from the  
...m. The State of Victoria accepts no responsibility for any subsequent release, publication or reproduction of the information.

**LP71049**  
**EDITION 1**  
APPROVED 19/1/1966

PLAN OF SUBDIVISION OF  
PART OF CROWN ALLOTMENT 2 SECTION 2  
PARISH OF MORDIALLOC  
COUNTY OF BOURKE

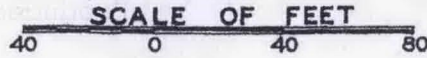

*The land colored blue is set apart for drainage & sewerage purposes*  
*The land colored green is set apart for the supply of electricity.*

**COLOUR CONVERSION**  
E-1=BLUE  
E-2=GREEN

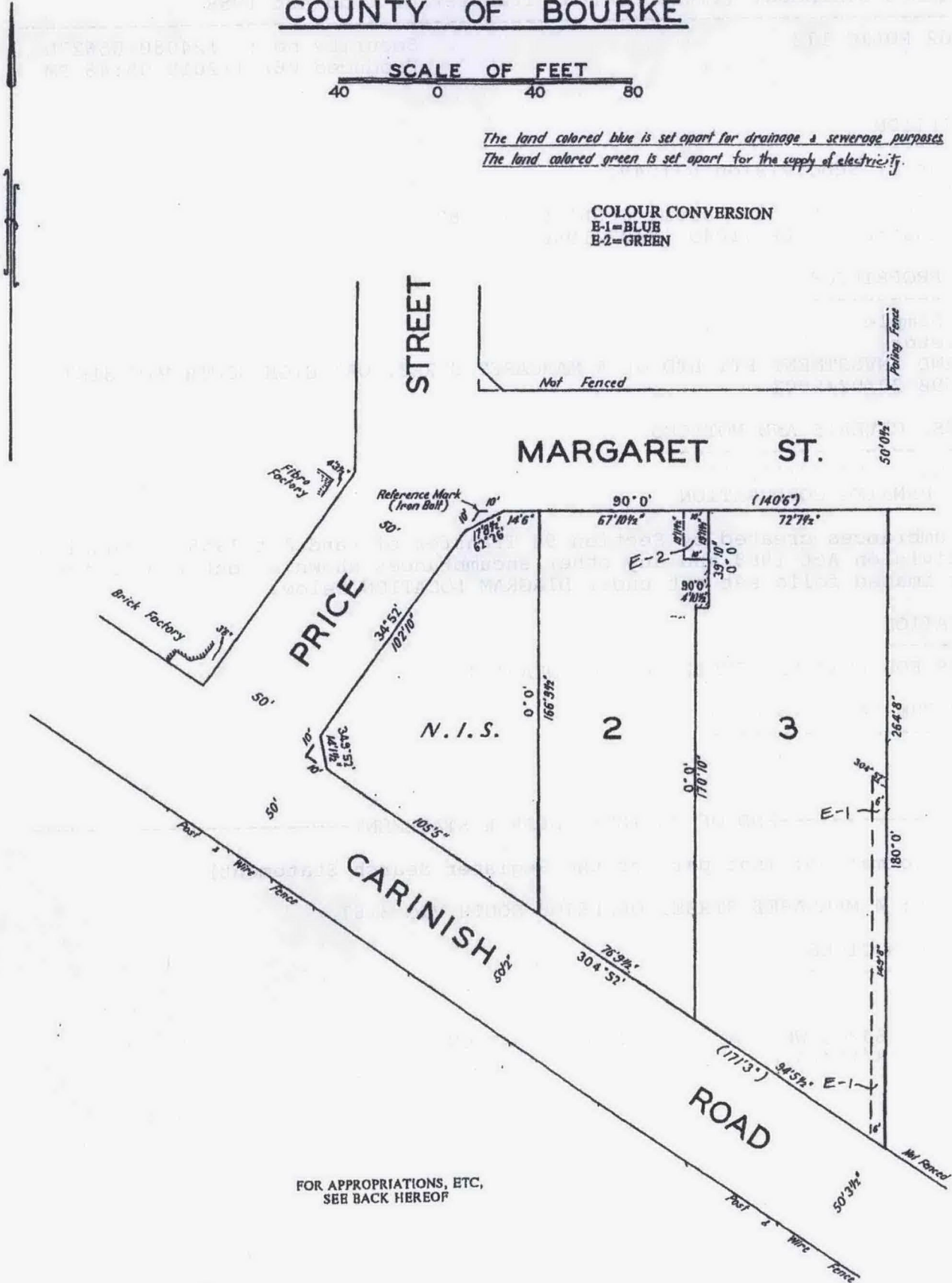

FOR APPROPRIATIONS, ETC,  
SEE BACK HEREOF

CERTIFICATE OF TITLE V. 8566' <sup>581</sup> F. 8821'  
 LODGED BY DAVIES CAMPBELL & CO  
 DATE 19.10.65  
 DECLARED BY J. W. McQUIE 29.6.65  
 CONSENT OF COUNCIL CITY OF OAKLEIGH  
28.9.65  
 \_\_\_\_\_  
 PLAN APPROVED DATE 19.1.66 TIME 3.10.

LP ..... 71049 .....  
 BACK OF SHEET 1 .....

THE LAND COLOURED BLUE  
 IS APPROPRIATED  
 OR SET APART FOR  
 EASEMENTS OF DRAINAGE & SEWERAGE.

THE LAND COLOURED GREEN  
 IS APPROPRIATED  
 OR SET APART FOR  
 SUPPLY OF ELECTRICITY.