

LEGEND

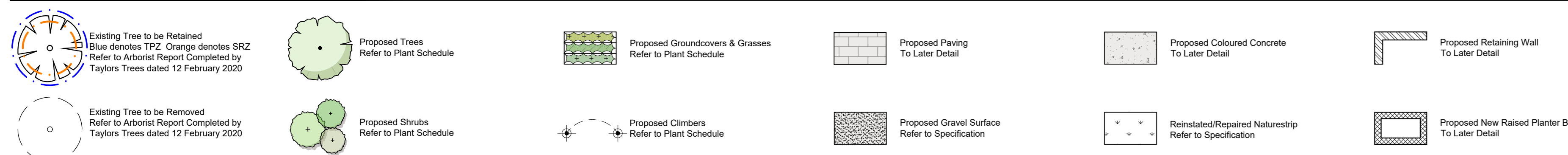

PLANT SCHEDULE

SYM	BOTANICAL NAME	COMMON NAME	DE/NE*	HEIGHT X WIDTH AT MATURITY	MIN SUPPLY SIZE	QTY
TREES						
APA	<i>Acer palmatum</i> 'Atropurpureum'	Purple Leaf Japanese Maple	DE	4x 3m	50cm/2.0mH	4
APF	<i>Acer rubrum</i> 'Flame Tree'	Red Maple /Flame Tree	DE	11 x 7m	50cm/2.0mH	4
ER	<i>Eucalyptus reticulata</i>	Blakely Ash	EN	9 x 4m	50cm/2.0mH	3
LB	<i>Lagerstroemia indica</i> x <i>L. fauriei</i> 'Blot'	Blaze Orange Myrtle	DE	7 x 5m	50cm/2.0mH	4
MG	<i>Magnolia grandiflora</i>	Bull Bay Magnolia	EN	16 x 8m	50cm/2.0mH	2
PSD	<i>Pyrus betulaefolia</i> 'Southern Hill Dancer'	Southern Hill Ornamental Pear	DE	7.4 x 5m	50cm/2.0mH	2
TL	<i>Trochodendron araliifolium</i>	Luscious Kanooka/Water Gum	EN	7.4 x 5m	50cm/2.0mH	2
						TOTAL
SHRUBS						
AAZ	<i>Azalea</i> 'Alba Magnifica'	White Azalea	EN	1.2 x 1.2m	200mm pot	200
CR	<i>Correa reflexa</i>	Common Correa	EN	1 x 1 m	200mm pot	200
CA	<i>Camelia sasanqua</i> 'Assura'	Assura Camellia	EN	3 x 1m	200mm pot	200
MM	<i>Munroa paniculata</i> 'Munroa'	Dee Dee Orange Jasminum	EN	1 x 1m	200mm pot	200
SC	<i>Syzygium australe</i> 'Bush Christmas'	Bush Christmas Lily-illy	EN	2 x 1m	200mm pot	200
						TOTAL
GROUNDCOVERS						
EA	<i>Diandra tasmanica</i> 'Emerald Arch'	Emerald Arch Flax Lily	EN	0.45 x 0.45m	140mm pot	200
DL	<i>Dianella caerulea</i> 'Little Jess'	Little Jess Paroo Lily	EN	0.4 x 0.4m	140mm pot	200
OP	<i>Dianella longifolia</i> var. <i>longifolia</i>	Pink Flax Lily	EN	0.75 x 0.75m	140mm pot	200
LT	<i>Lomandra longifolia</i> 'Tassie'	Tasmanian Hair-rush	EN	0.6 x 0.6m	140mm pot	200
LP	<i>Limonium perrieri</i>	Sea Lavender	EN	0.6 x 0.6m	140mm pot	200
OT	<i>Ophiopogon japonicus</i>	Giant Mondo Grass	EN	0.4 x 0.4m	140mm pot	200
TJ	<i>Trachelospermum asiaticum</i>	Yellow Star Jasmine	EN	0.2 x Spreading	140mm pot	200
VH	<i>Viburnum hederae</i>	Narrow Violett	EN	0.15 x Spreading	140mm pot	200
						TOTAL
CLIMBERS						
Fp	<i>Ficus pumila</i>	Climbing Fig	EN	Self-clinging climber	140mm pot	200
Vc	<i>Vitis coignetiae</i>	Crisson Glory Vine	EN	Climber	140mm pot	200
						TOTAL

EXISTING VEGETATION SCHEDULE

No.	BOTANICAL NAME	COMMON NAME	HEIGHT X WIDTH	Tree Protection Zone (TPZ) Radius	SRZ Radius	RETAIN REMOVE	COMMENTS
1	<i>Camellia japonica</i>	Japanese Camellia	4 x 3	2.0m	1.5m	Retain	Third party on nership
2	<i>Melaleuca sp.</i>	Peppercorn	6 x 3	2.0m	1.5m	Retain	Third party on nership
3	<i>Ligustrum lucidum</i>	Broadleaf Privet	3 x 3	2.0m	1.5m	Retain	Third party on nership
4	<i>Prunus cerasifera</i> 'Nigra'	Black Cherry Plum	3 x 3	2.0m	1.5m	Retain	Third party on nership
5	<i>Acer palmatum</i>	Japanese Maple	6 x 6	4.2m	2.4m	Retain	Third party on nership
6	<i>Prunus cerasifera</i> 'Nigra'	Black Cherry Plum	6 x 5	2.4m	1.7m	Retain	Council Street Tree
7	<i>Prunus sp.</i>	Prunus	6 x 5	3.0m	2.1m	Retain	Council Street Tree
8	<i>Prunus sp.</i>	Prunus	4 x 4	2.2m	1.5m	Remove	Council Street Tree - Low Retention Value
9	<i>Malus sp.</i>	Crab Apple	1.5 x 0.7	2.0m	1.5m	Retain	Council Street Tree
10	<i>Malus sp.</i>	Crab Apple	1.5 x 0.7	2.0m	1.5m	Retain	Council Street Tree
11	<i>Malus sp.</i>	Crab Apple	6 x 5	2.8m	1.8m	Retain	Council Street Tree
12	<i>Malus sp.</i>	Crab Apple	5 x 4	3.0m	1.9m	Retain	Council Street Tree
13	<i>Lophospermum confertus</i>	Queensland Brush Box	9 x 6	4.8m	2.4m	Retain	Council Street Tree
14	<i>Nerium Oleander</i>	Oleander	4 x 4	2.0m	1.5m	Retain	Third party on nership

TYPICAL PLANTING DETAILS

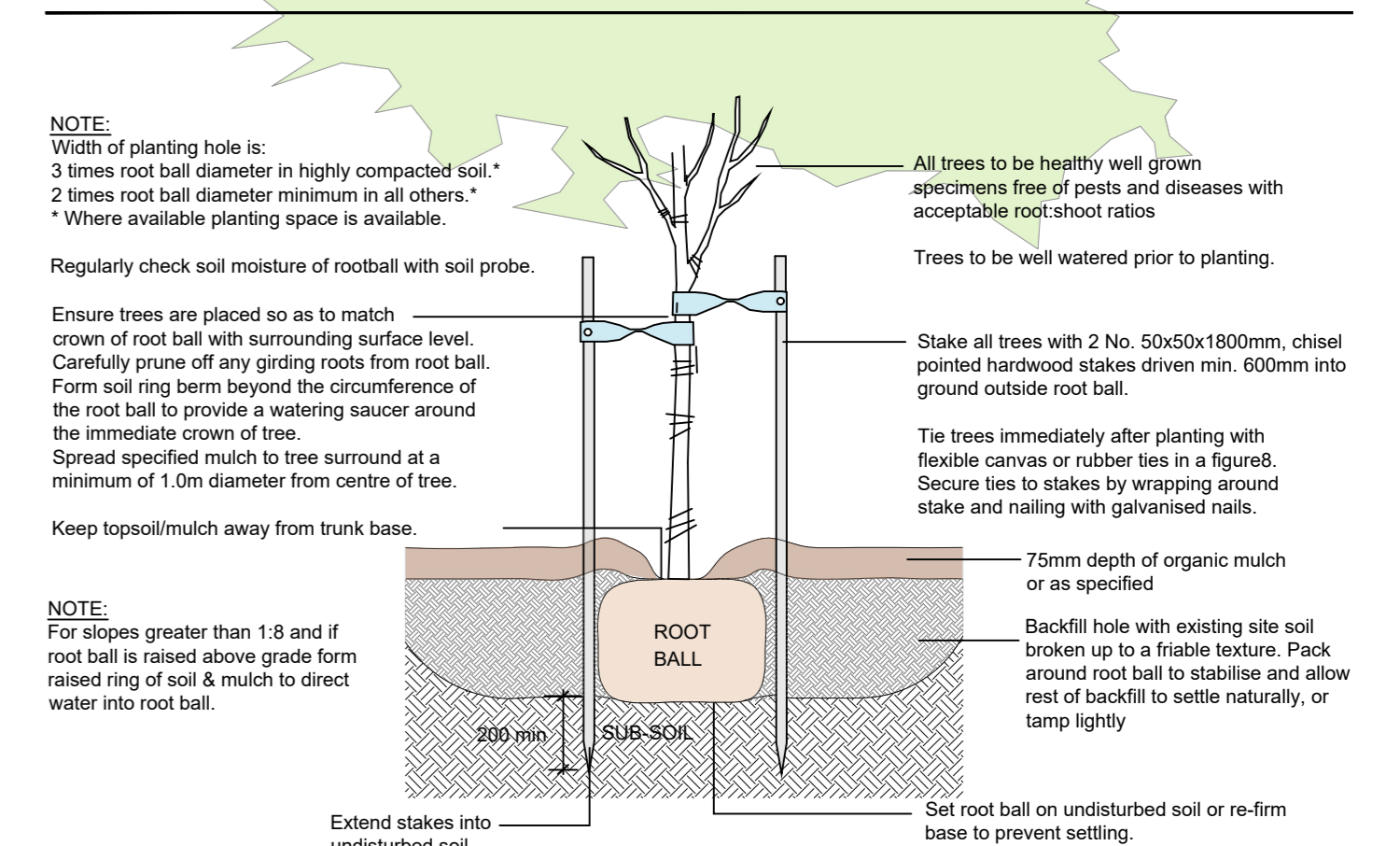

D1 TYPICAL TREE PLANTING DETAIL

Scale N:1.5

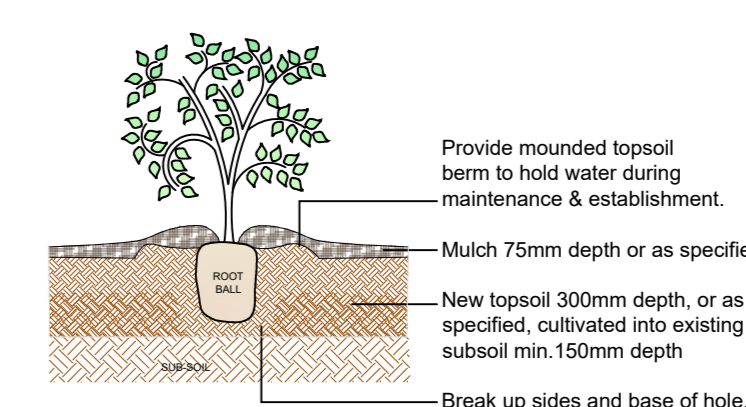

D2 TYPICAL SHRUB PLANTING DETAIL

Scale N:1.5

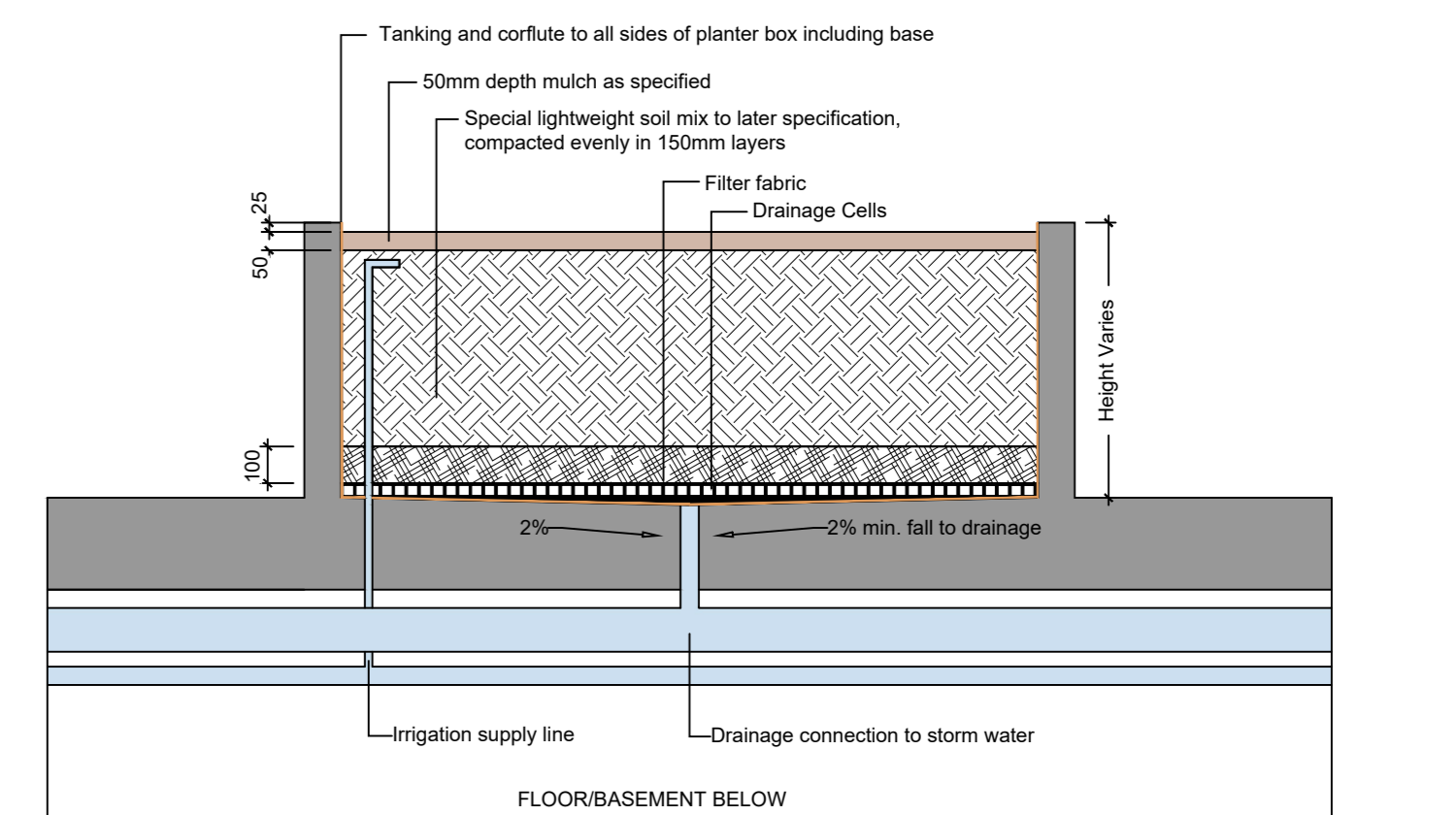

D3 TYPICAL LIGHTWEIGHT PLANTER BOX DETAIL

Scale 1:20

SPECIFICATION NOTES

Soil Preparation
Cracked rock, concrete spillage and any other material restrictive to plant growth (e.g. large rocks) shall be removed from the site of any planting beds and replaced with topsoil. All trees to be removed shall be stump ground and all rubble/vegetative spoil is to be removed from site. Existing top soil in planting areas is to be preserved so that it does not receive additional compaction from site machinery and so that no rubble or building supplies are stored in these areas.

Weed Removal
All weeds shall be thoroughly removed. All vegetative material, including roots and rhizomes of non-woody perennials and woody succulent weeds, is to be removed or adequately controlled using chemical means. The stumps of non-succulent woody perennials are to be stump ground. All vegetative material shall be appropriately disposed of off site in a manner which will not allow their re-establishment elsewhere. Any chemical controls are to be used in accordance with manufacturer's instructions and standard occupational health and safety procedures. Care must be taken to ensure that all trees to be retained and any herbicides used are suitable for use around the vegetation to be retained.

Planting
Planting shall be carried out using accepted horticultural practices with all plants conforming to the species, size and quantities indicated on the Landscape Plan and Plant Schedule. Plants shall be thoroughly soaked through immersion in water prior to planting and the planting soil is very dry then the planting hole is also to be filled with water and allowed to drain completely.

Plant Establishment Period
These shrubs are to be planted in the nursery. Use Establishment Period following the approval of Practical Completion by the responsible authority. During this period the landscape contractor shall make good all defects in higher scope of works. Maintenance and Establishment means the care and maintenance of the contract area by accepted horticultural practices, as well as rectifying any defects that become apparent in the work under normal use. This shall include, but shall not be limited to watering, fertilising, weeding, pruning, pest and disease control, calibration, re-staking and replacement of any plants that fail with plants of the same species and size.

Mulch
Mulch is to be supplied to all garden beds and is to be an organic type laid to a minimum depth of 75mm, consisting of fine dark coloured chipped or shredded pine bark or hardwood with not more than 2% fines content by volume (generally zero fines). The average size of the woody material must be approximately 10mm x 20mm x 5mm, and the maximum length is not to exceed 30mm. Mulch shall be free of damaging matter such as soil, weeds and sticks and is to be accepted and thoroughly weathered prior to delivery. Mulch is to be kept back 100mm from the stems of all plants to prevent rot.

Timber Edges
Provide 75 x 25mm treated pine edges to all borders between gravel mulch paths and garden beds using 75x25x3000mm long treated pine stakes at 1200mm maximum centres. An additional stake is to be provided at joints in the path.

Irrigation
An approved drip irrigation system is to be supplied to all planter boxes & garden beds. An approved pop-up spray system is to be supplied to all lawn areas. It is the responsibility of the contractor to ensure that all irrigation meets manufacturer's specifications. The system is to be connected to mains supply and include a manual off device. All drips are to be buried with approx. 50mm of topsoil cover and shall be anchored at equal intervals to ensure the tubing cannot be dislodged.

Raised Planter Boxes
Raised planter construction is to include, but not necessarily be limited to, the supply and installation of agricultural drains, drainage cells at base, filter fabric, planting medium, mulch and irrigation. Planter boxes must be effectively finished on all sides with concrete to prevent leaching.

Drainage Cells
Drainage cells are to be provided at the base of the planter and are to be covered with a layer of filter fabric. A drainage outlet is to be installed in the base of the planter with the floor of the planter sloped towards it. Provide a rock trench if trees are to be planted in a windy location.

Supply and spread evenly a special lightweight planter mix. (to be advised) Compact evenly in 100mm layers. Avoid differential subsidence and ensure compaction and produce a finished surface that is graded evenly and ready for planting. Allow for 50mm layer of specified mulch to top of beds and a finished level 25-50mm below the planter rim. (Drip irrigation as specified is to be installed beneath the mulch layer.)

ADVERTISED COPY - CITY OF MONASH
This copied document is made available for the sole purpose of enabling its consideration and review as part of a planning process under the Planning and Environment Act.
The document must not be used for any purpose which may breach copyright.

