

ADVERTISED COPY - CITY OF MONASH
This copied document is made available for the sole purpose of enabling its consideration and review as part of a planning process under the Planning and Environment Act.
The document must not be used for any purpose which may breach copyright.

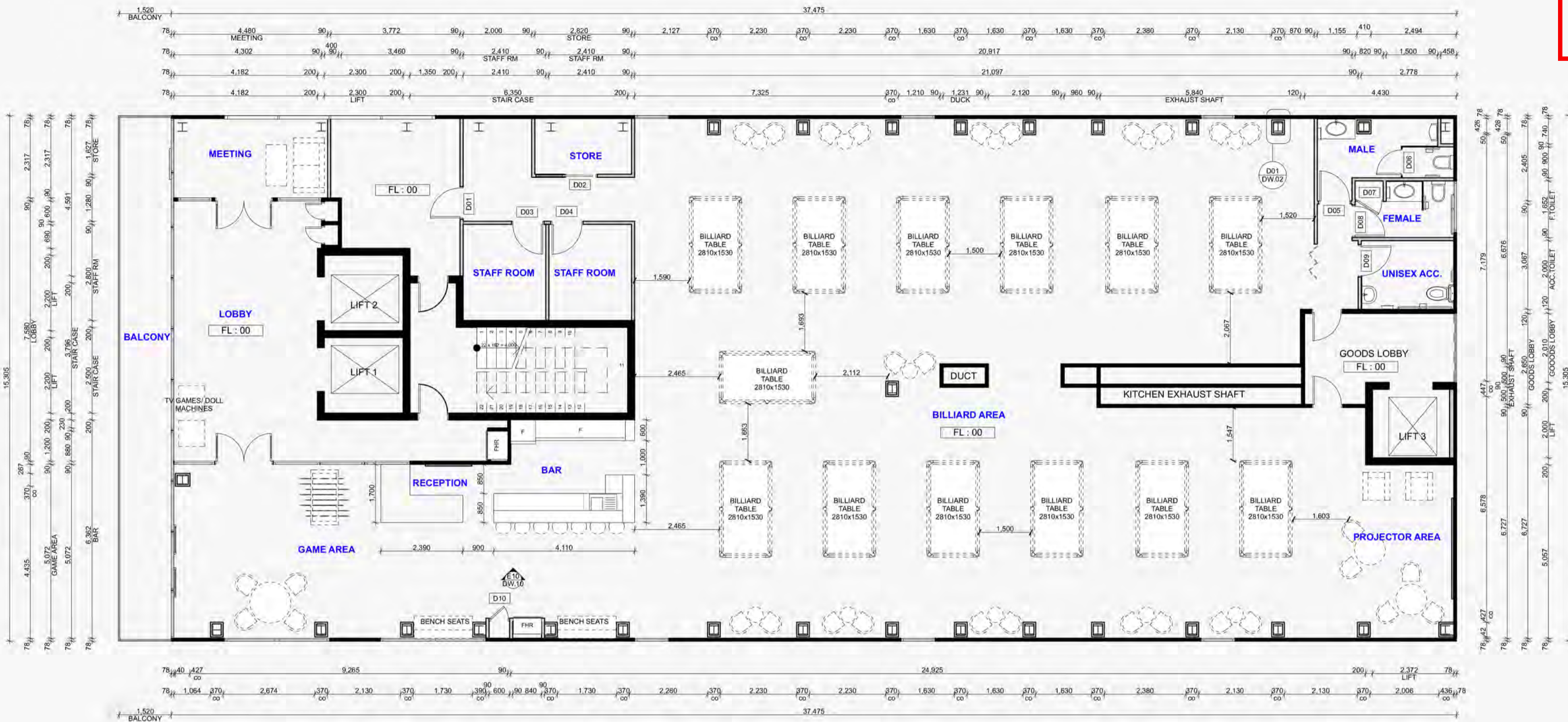

SHOP 11 & 12, LEVEL 5, 52 MONTCLAIR AVE, GLEN WAVERLEY BILLIARDS/SNOOKER LOUNGE - PLACE OF ASSEMBLY (TOTAL 120)

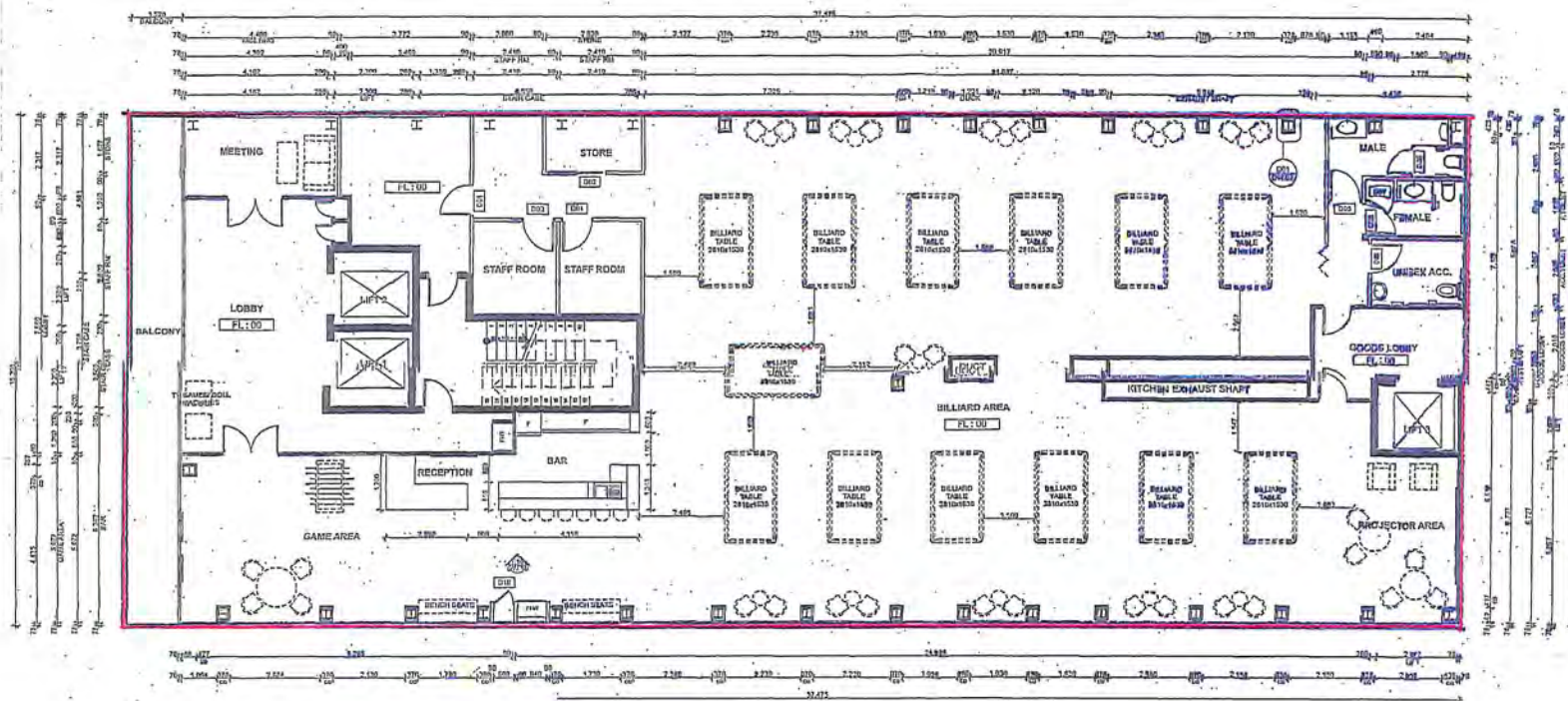

SHOP 11 & 12 LEVEL 5, 52 MONTCLAIR AVE GLEN WAVERLEY
BILLIARDS/SNOOKER LOUNGE -
PLACE OF ASSEMBLY (TOTAL 120)

ADVERTISED COPY - CITY OF MONASH
 This copied document is made available for the sole purpose of enabling its consideration and review as part of a planning process under the Planning and Environment Act. The document must not be used for any purpose which may breach copyright.

Attachment 2: 52 Montclair Avenue, Glen Waverley





Planning Overlays and Zones

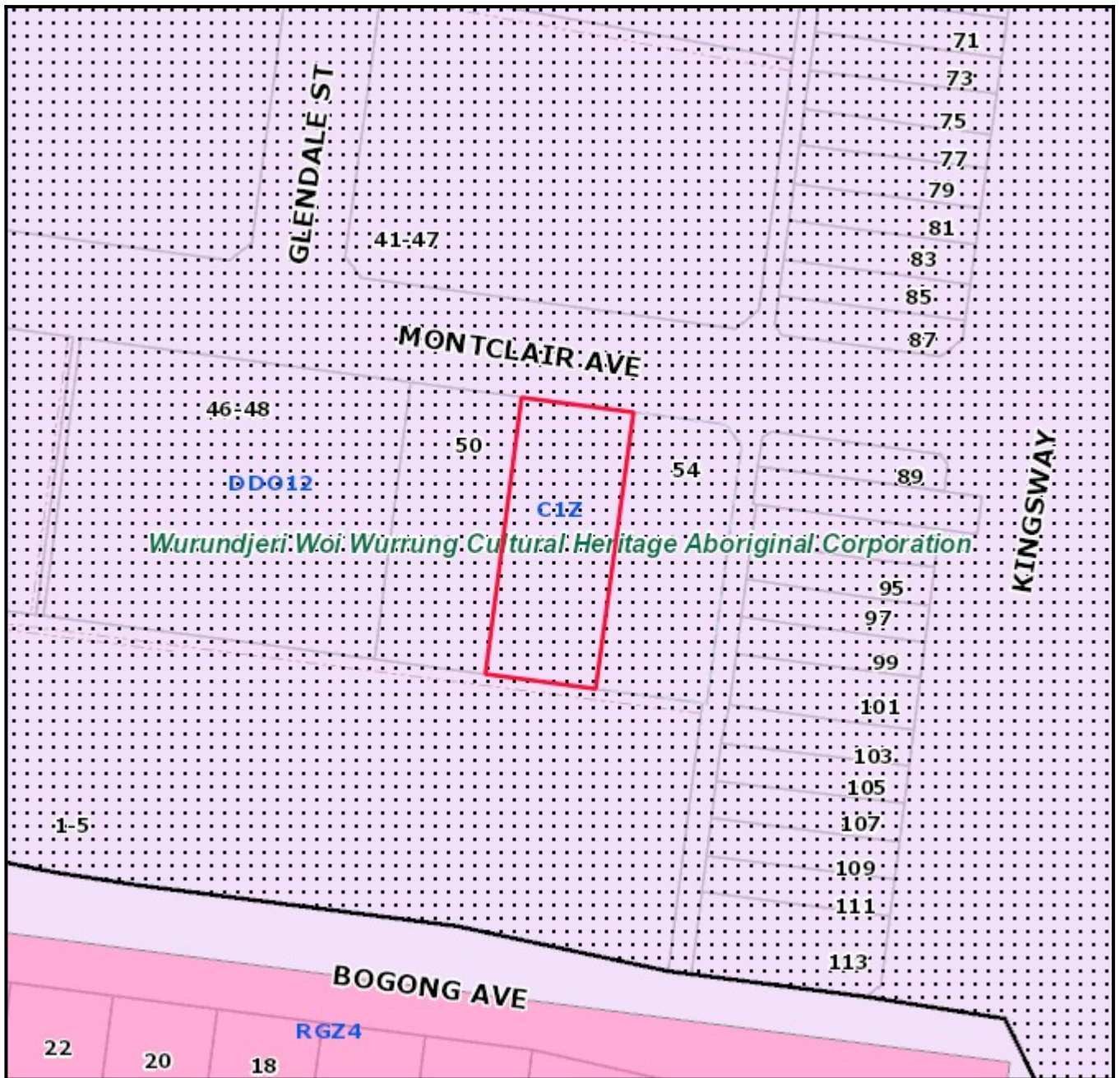

Legend

Planning Zones

Planning Overlays

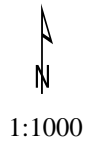

Address: Ground Lvl Shop 1/52 Montclair Avenue GLEN WAVERLEY VIC 3150

Area: 0 sqm

Base data is supplied under Licence from Land Victoria. This map is for general use only and may not be used as proof of ownership, dimensions or any other status. The information must be verified before taking any action which may be affected by a planning scheme requirement. This can be done by visiting the website: <http://services.land.vic.gov.au/landchannel/content/>

The City of Monash endeavours to keep the information current, and welcomes notification of omissions or inaccuracies.

